

Coins tray  
(Parts D: Sheets 1, 5)

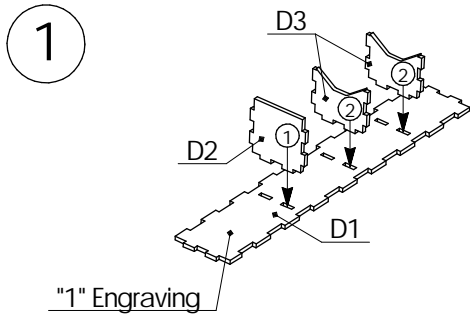

Player tray (x6)  
(Parts E: Sheets 6-11)

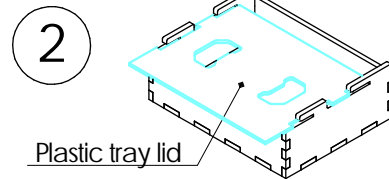
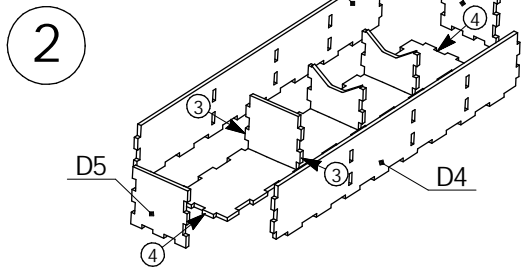
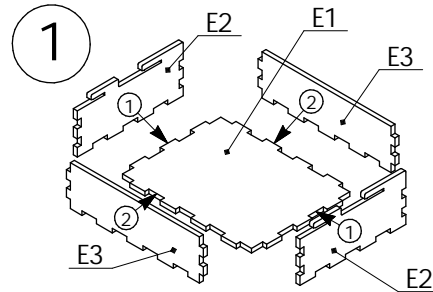

COMPATIBLE WITH  
**CLANK! AND ITS EXPANSIONS**  
SUNKEN TREASURES, THE MUMMY'S CURSE,  
ADVENTURING PARTY, EXPEDITIONS: GOLD AND SILK,  
EXPEDITIONS: TEMPLE OF THE APE LORDS.

# CLANG

## ORGANIZER REVISION 3

This is a third-party accessory designed by Gaming Trunk. All product names are trademarks of their respective owners, which are in no way associated or affiliated with Gaming Trunk.



[gamingtrunk.com](https://gamingtrunk.com)



[info@gamingtrunk.com](mailto:info@gamingtrunk.com)



[fb.com/GamingTrunk](https://fb.com/GamingTrunk)



[pinterest.com/gamingtrunk](https://pinterest.com/gamingtrunk)



Gaming Trunk  
<https://gamingtrunk.com>  
Copyright © 2022 Gaming Trunk  
Made in Canada

Made in Canada

# Assembly manual

Thank you for purchasing our Clang! organizer Revision 3 for Clank! and the expansions.  
A digital copy of the manual is available for download on [gamingtrunk.com](http://gamingtrunk.com)

## Tools required

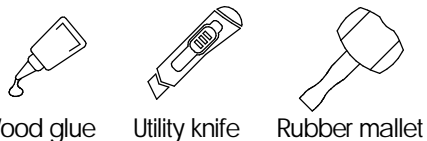

Wood glue    Utility knife    Rubber mallet

The organizer assembly requires about 90 minutes.  
The organizer is designed for no-glue assembly. However, applying some glue on the corner connections will increase trays durability. Due to variances in wood, a rubber mallet or glue might be required to secure the pieces together.

We recommend wood glue or another comparable quick setting, tacky glue.

## Assembly tips:

- Use utility knife to cut parts out of the sheets. Panching parts may cause wood splitting.
- Some connections may feel too tight. Use of a rubber mallet is recommended to set the parts on their place.
- Due to the cutting process, some pieces may vary slightly. If the piece is symmetrical reversing it may help

Card tray  
(Parts A; Sheets 1, 2)

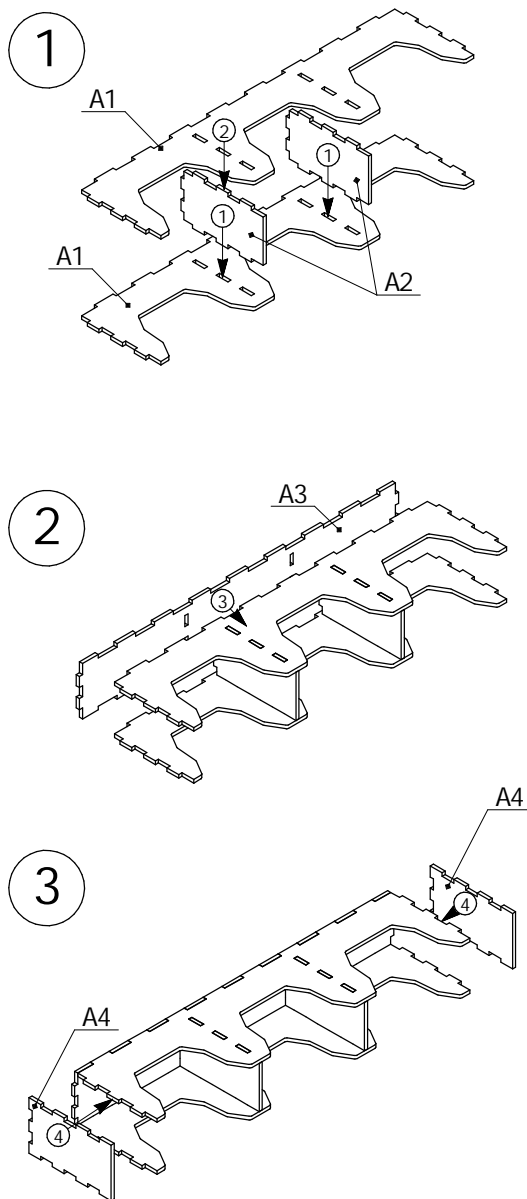

Reserve Cards tray  
(Parts B; Sheets 2, 3)

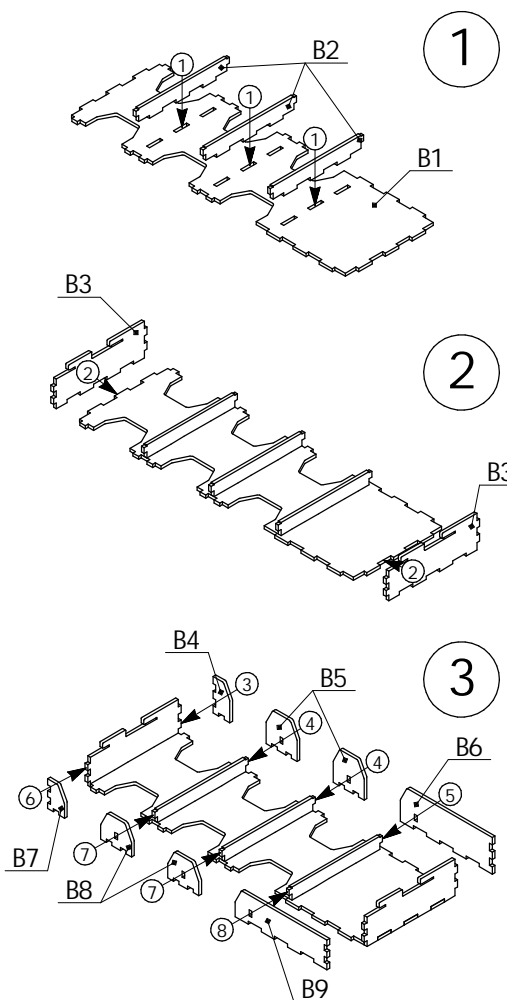

Tokens tray  
(Parts C; Sheets 2, 4)

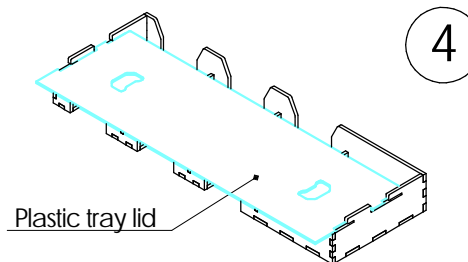
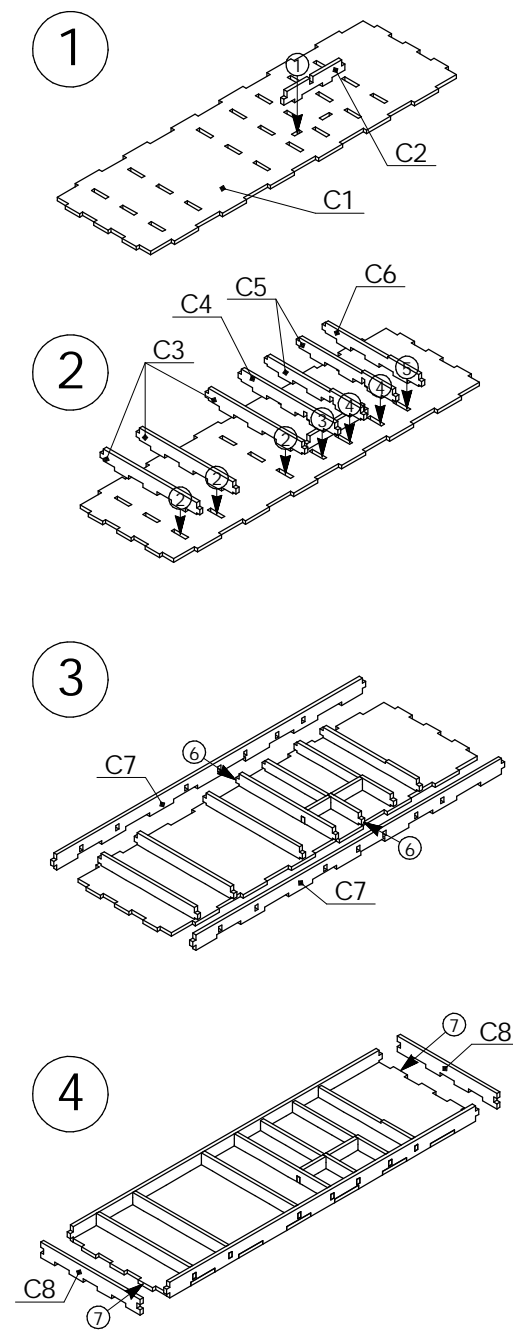

Please remove protective film from the tray lids before use

