



COMPATIBLE WITH  
LOST RUINS OF ARNAK

# ARNAK

## ORGANIZER

This is a third-party accessory designed by Gaming Trunk. All product names are trademarks of their respective owners, which are in no way associated or affiliated with Gaming Trunk.

Made in Canada



GT-ORG-AR-01

[gamingtrunk.com](https://gamingtrunk.com)



[info@gamingtrunk.com](mailto:info@gamingtrunk.com)



[fb.com/GamingTrunk](https://fb.com/GamingTrunk)



[pinterest.com/gamingtrunk](https://pinterest.com/gamingtrunk)



Gaming Trunk  
<https://gamingtrunk.com>  
Copyright © 2021 Gaming Trunk  
Made in Canada

# Assembly manual

Thank you for purchasing our Arnak organizer for Lost Ruins of Arnak.  
A digital copy of the manual is available for download on [gamingtrunk.com](http://gamingtrunk.com)

## Tools required



The organizer assembly requires about 90 minutes.  
The organizer is designed for no-glue assembly. However, applying some glue on the corner connections will increase trays durability. Due to variances in wood, a rubber mallet or glue might be required to secure the pieces together.

We recommend wood glue or another comparable quick setting, tacky glue.

Assembly tips:  
- Use utility knife to cut parts out of the sheets. Panching parts might cause wood splitting.  
- Some connections may feel too tight. Use of a rubber mallet is recommended to set the parts on their place.  
- Due to the cutting process, some pieces may vary slightly. If the piece is symmetrical reversing it may help

## Tokens tray (x2) (Parts A; Sheets 1, 2, 8)

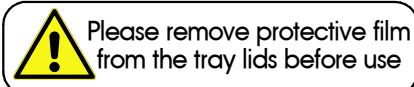
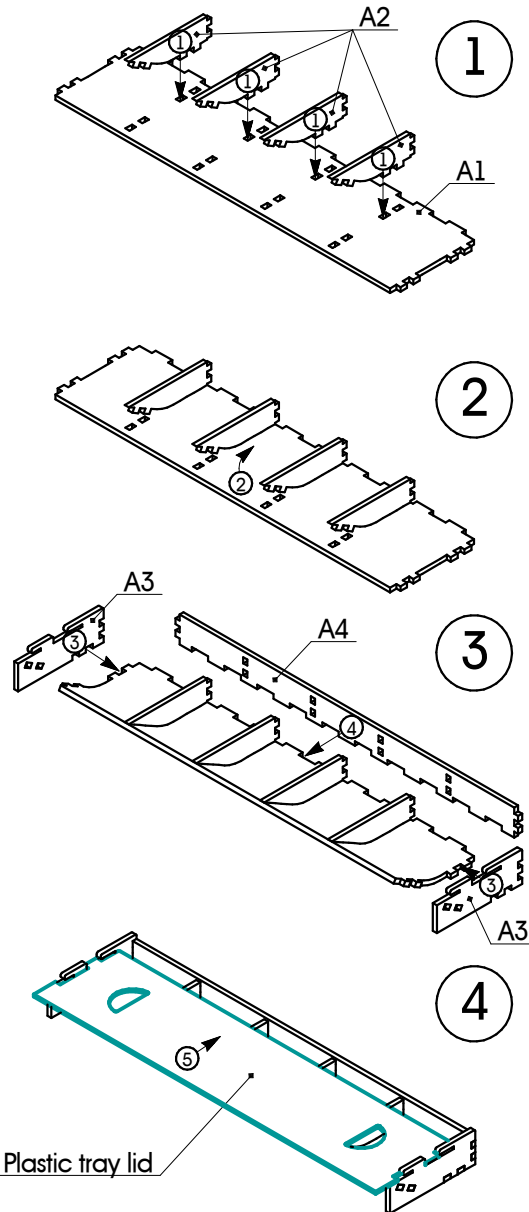

## Guardian tray (Parts B; Sheets 3, 4)

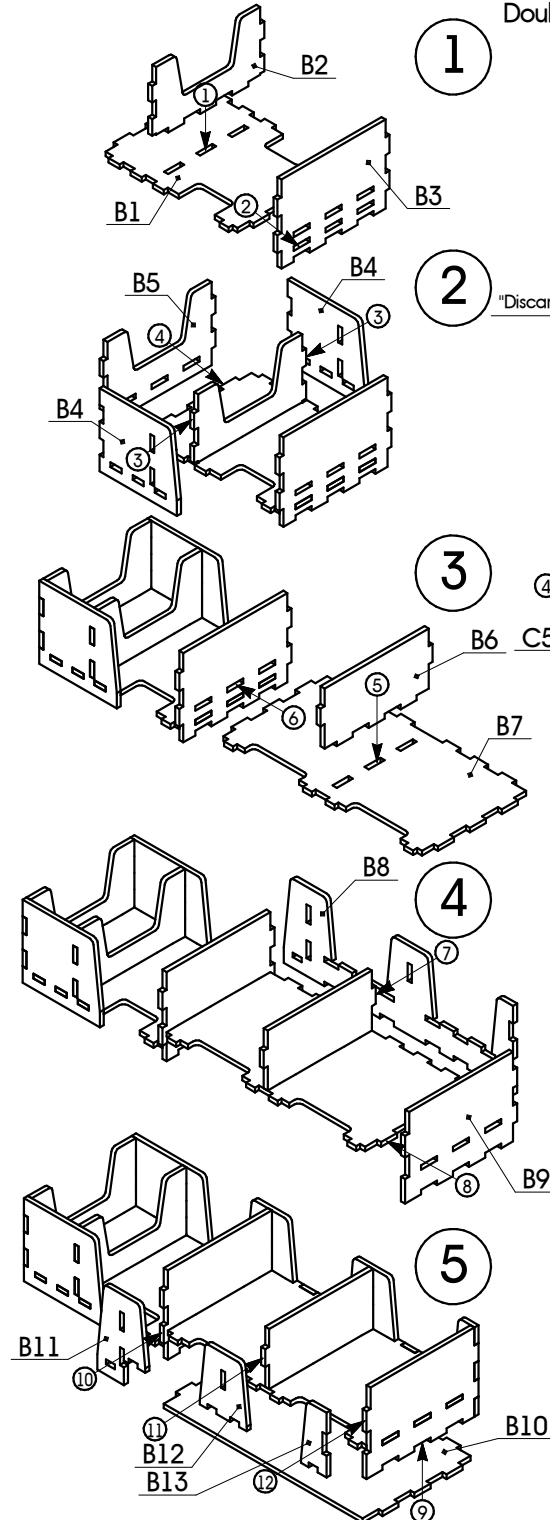

## Double card tray (x2) (Parts C; Sheets 1, 2, 5, 6, 7)

Double card trays are symmetrical to each other.  
Make sure that part C3 attached to part C1 beside "Discard" engraving

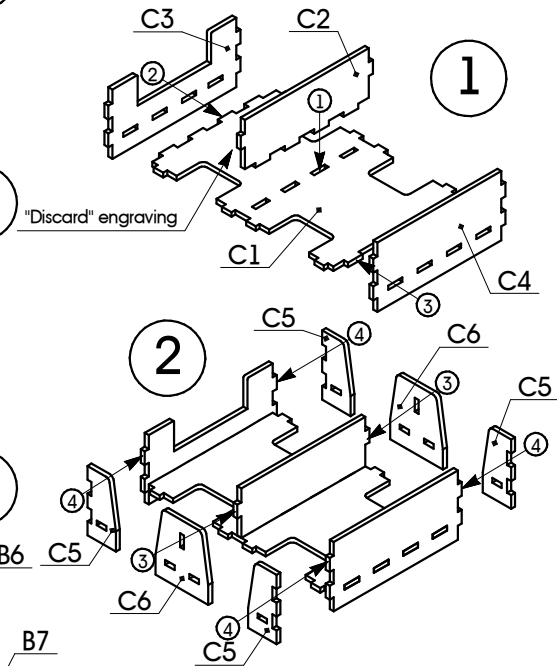

## Fear card tray (Parts D; Sheet 6, 8)

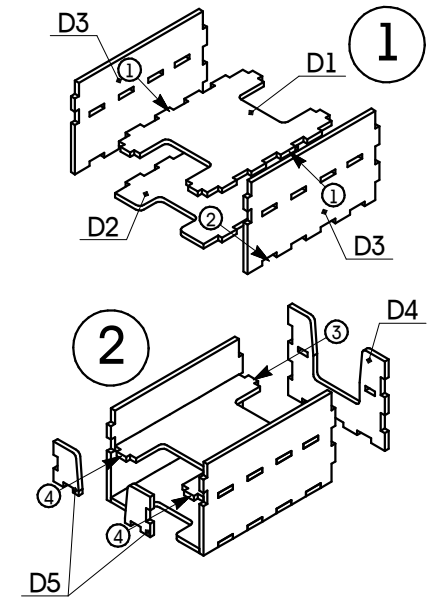

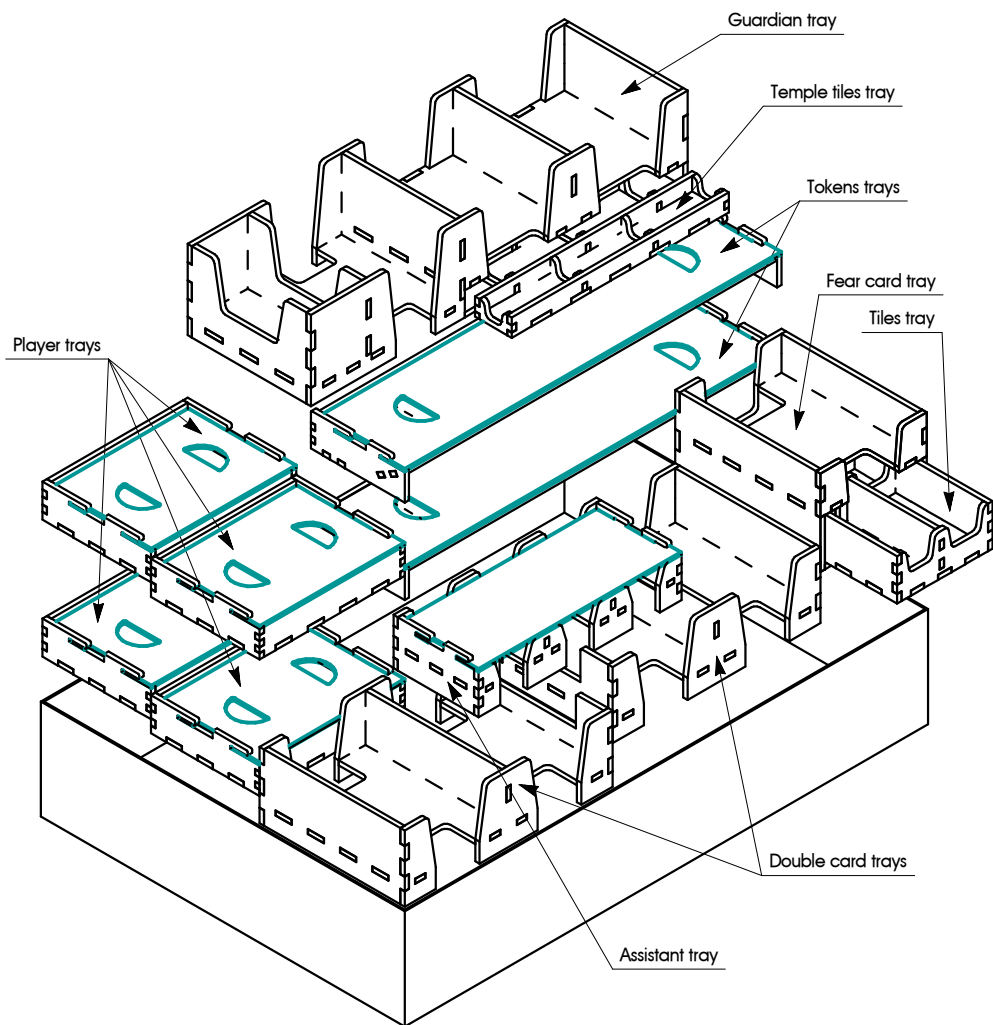

Temple tiles tray  
(Parts G; Sheet 8)

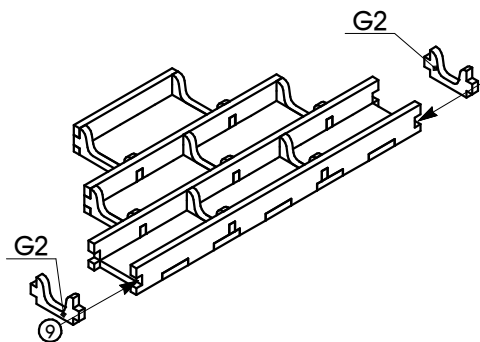
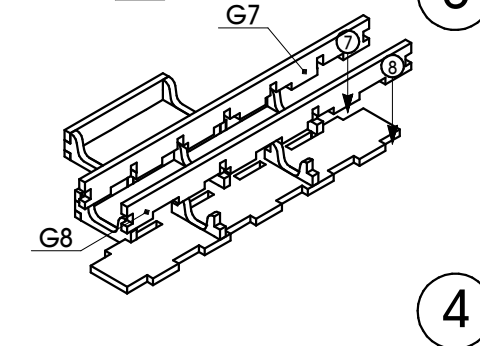
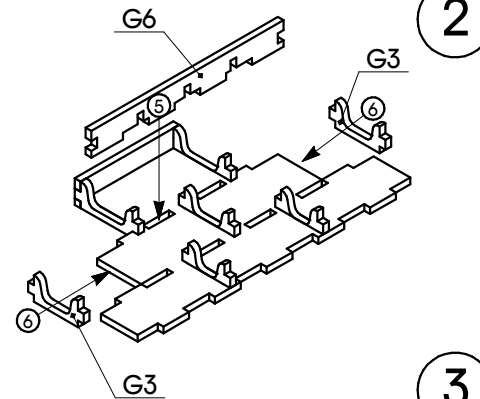
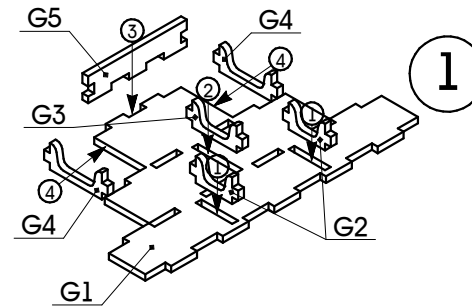

Tiles tray  
(Parts H; Sheet 7)

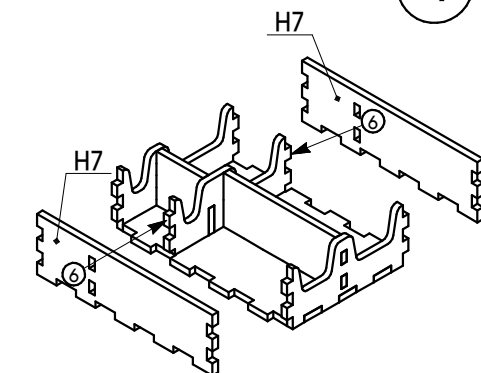
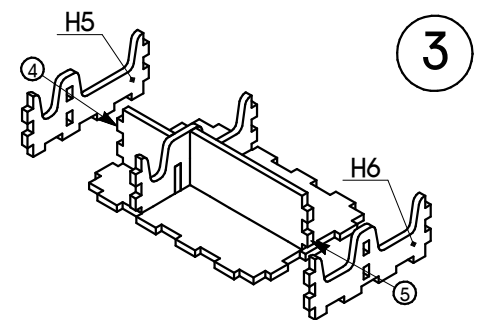
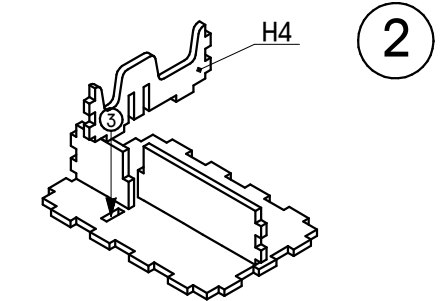
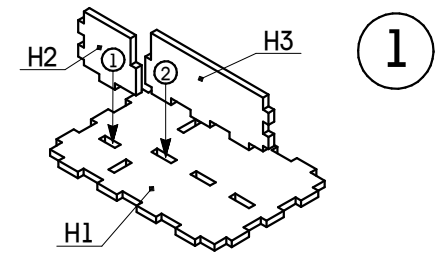

Assistant tray  
(Parts E; Sheet 8)

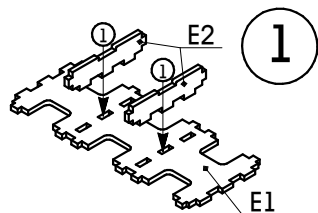

Player tray (x4)  
(Parts F; Sheets 9, 10)

