



COMPATIBLE WITH
TERRAFORMING MARS:
ARES EXPEDITION

ARES

ORGANIZER

This is a third-party accessory designed by Gaming Trunk. All product names are trademarks of their respective owners, which are in no way associated or affiliated with Gaming Trunk.

Made in Canada



Gaming Trunk
<https://gamingtrunk.com>
Copyright © 2021 Gaming Trunk
Made in Canada

Assembly manual

Thank you for purchasing our Ares Organizer for Terraforming Mars: Ares Expedition.
A digital copy of the manual is available for download on gamingtrunk.com

Tools required

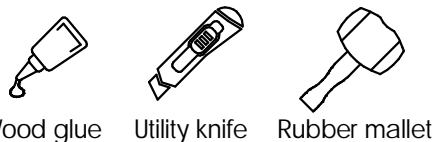

Wood glue Utility knife Rubber mallet

The organizer assembly requires about 90 minutes.

The organizer is designed for no-glue assembly. However, applying some glue on the corner connections will increase trays durability. Due to variances in wood, a rubber mallet or glue might be required to secure the pieces together.

We recommend wood glue or another comparable quick setting, tacky glue.

Assembly tips:

- Use utility knife to cut parts out of the sheets. Panching parts might cause wood splitting.
- Some connections may feel too tight. Use of a rubber mallet is recommended to set the parts on their place.
- Due to the cutting process, some pieces may vary slightly. If the piece is symmetrical reversing it may help

Card tray
(Parts A; Sheets 1, 2, 3, 5, 6)

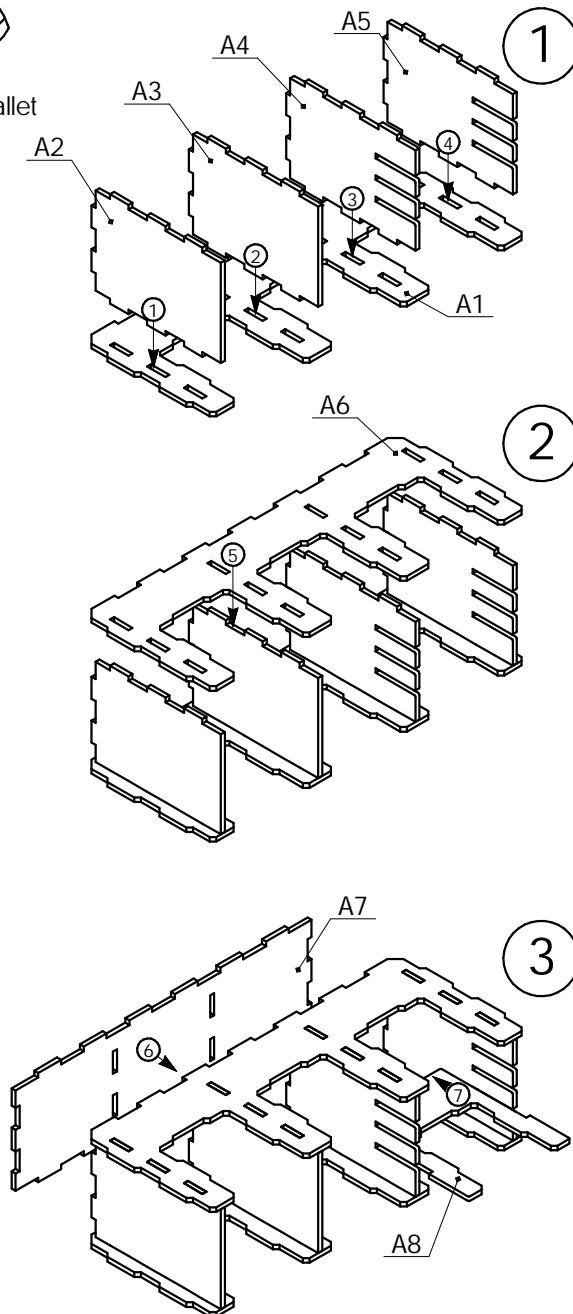

Player tray
(Parts B; Sheets 1, 3, 4)

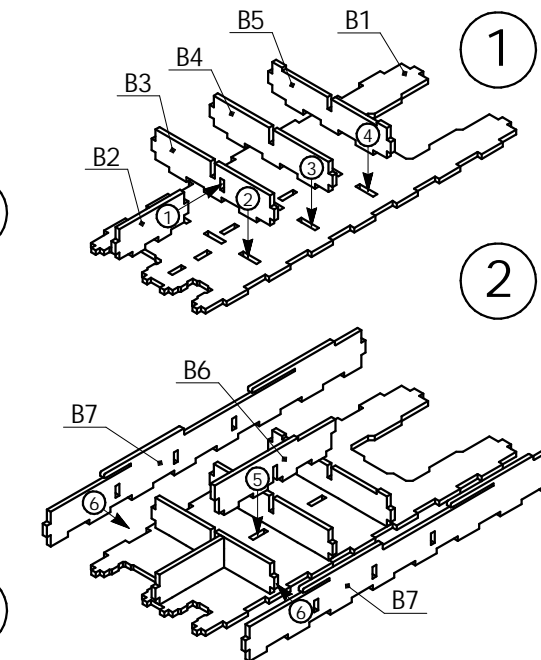

Tokens tray (x2)
(Parts C; Sheets 1, 2, 3, 5, 6)

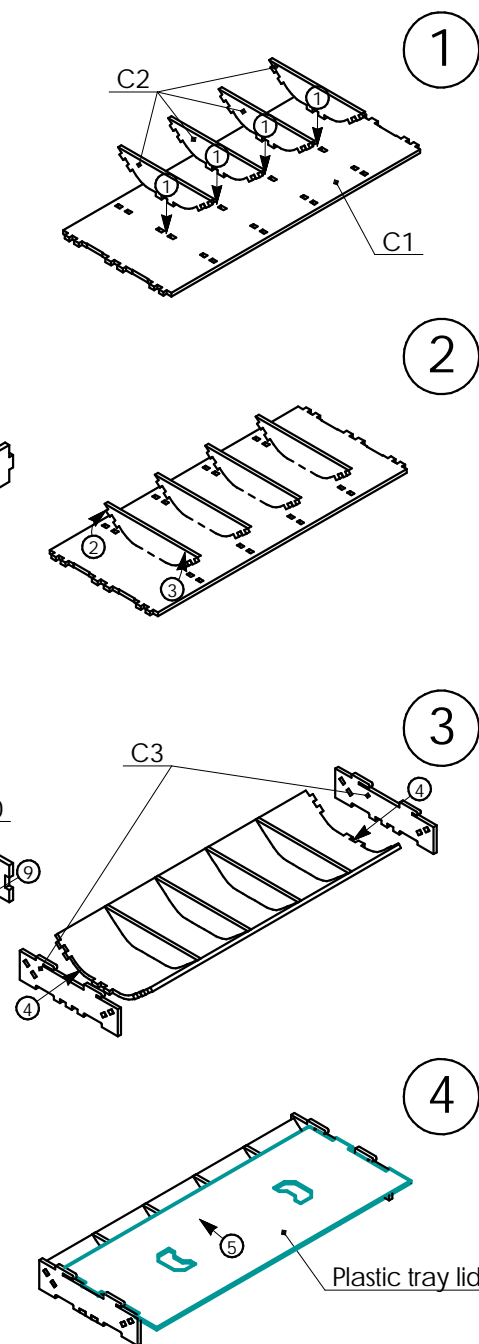

Please remove protective film from the tray lids before use