



COMPATIBLE WITH
ANKH: GODS OF EGYPT

ANKH

ORGANIZER

This is a third-party accessory designed by Gaming Trunk. All product names are trademarks of their respective owners, which are in no way associated or affiliated with Gaming Trunk.

Made in Canada



GT-ORG-AN-01

gamingtrunk.com



info@gamingtrunk.com



fb.com/GamingTrunk



pinterest.com/gamingtrunk



Gaming Trunk
<https://gamingtrunk.com>
Copyright © 2021 Gaming Trunk
Made in Canada

Assembly manual

Thank you for purchasing our Ankh organizer for Ankh: Gods of Egypt.
A digital copy of the manual is available for download on gamingtrunk.com



IMPORTANT: Assemble each tray one by one. Please **DO NOT** take out all the parts from the sheets and mix them. Even though some parts look similar, they are not interchangeable. Each miniature has a designated spot which is identified and matches the number on the miniature's base. An arrow beside the number shows which direction the miniature's head should face in order to fit.

Tools required

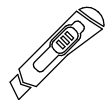

Wood glue Utility knife Rubber mallet

The organizer assembly requires 4+ hours.

The organizer is designed for no-glue assembly. However, applying some glue on the corner connections will increase trays durability. Due to variances in wood, a rubber mallet or glue might be required to secure the pieces together.

We recommend wood glue or another comparable quick setting, tacky glue.

Assembly tips:

- Use utility knife to cut parts out of the sheets. Punching parts might cause wood splitting.
- Some connections may feel too tight. Use of a rubber mallet is recommended to set the parts in their place.
- Due to the cutting process, some pieces may vary slightly. If the piece is symmetrical reversing it may help

God Miniatures Tray
(Parts A; Sheets 1, 2, 3)

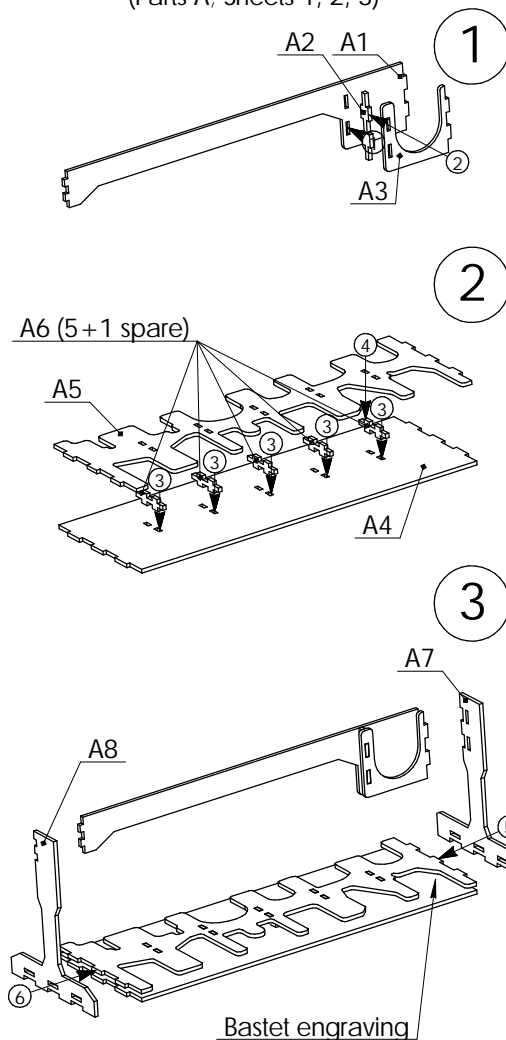

Guardian Tray 2
(Parts B; Sheets 4, 5, 6)

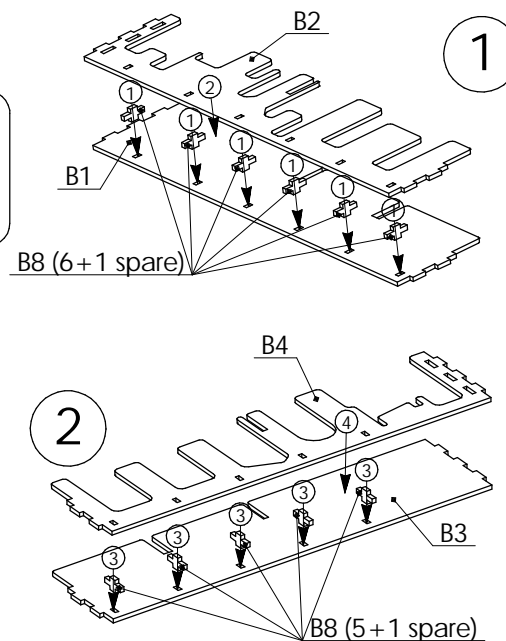

Guardian Tray 3
(Parts C; Sheets 7, 8)

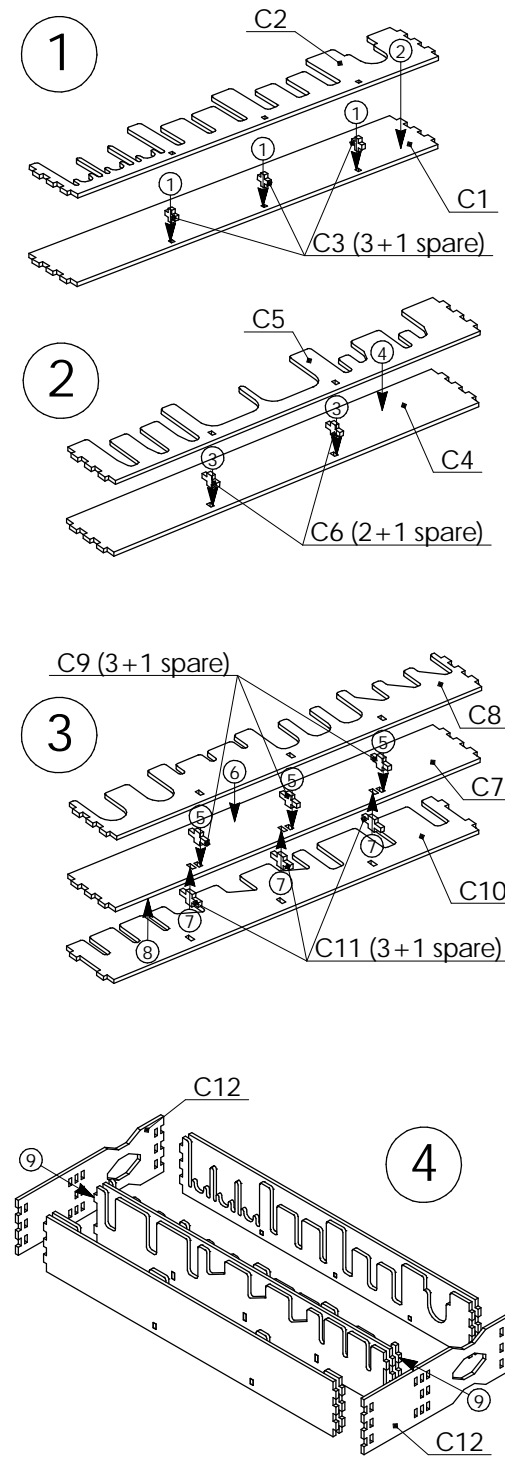

God Tray (x12)
(Parts I; Sheets 12-23)
Each sheet contains parts for one tray

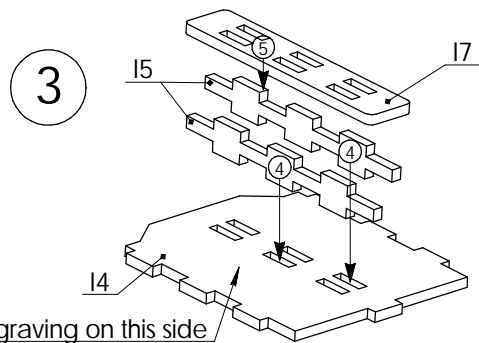
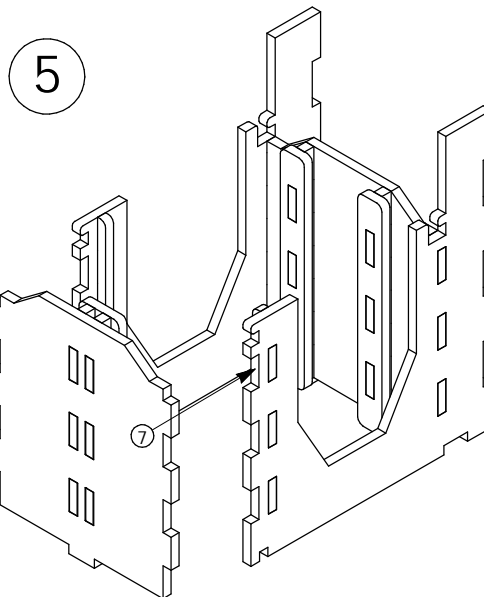
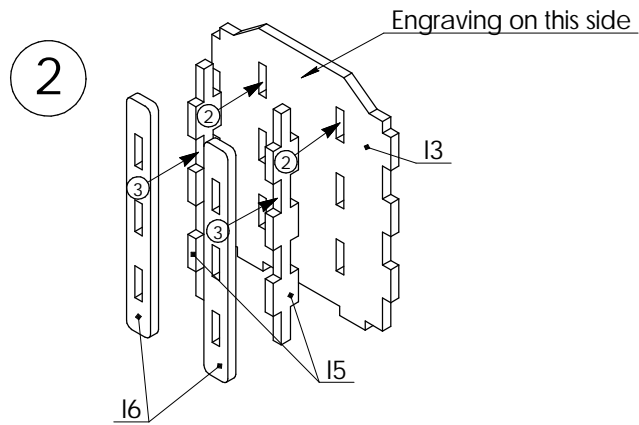
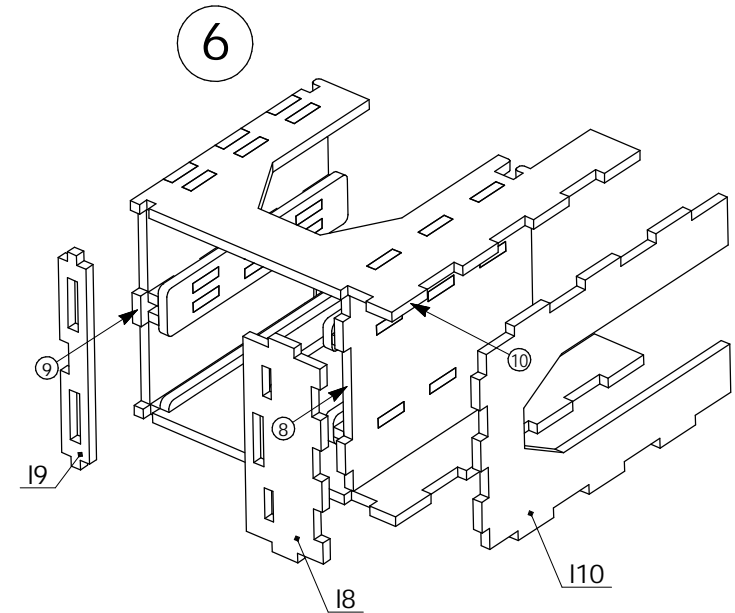
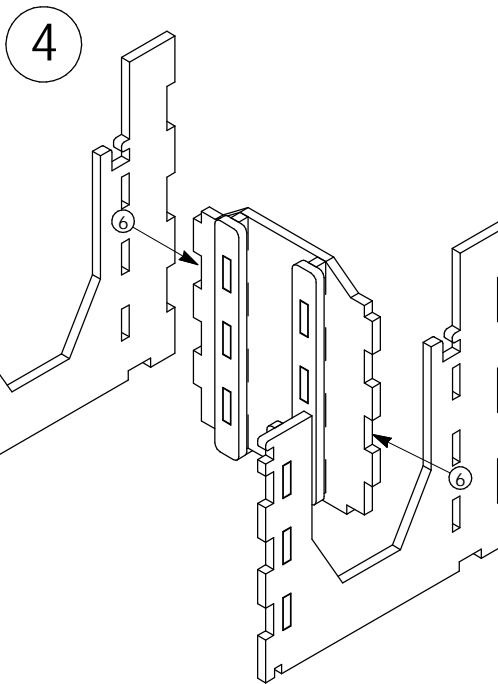
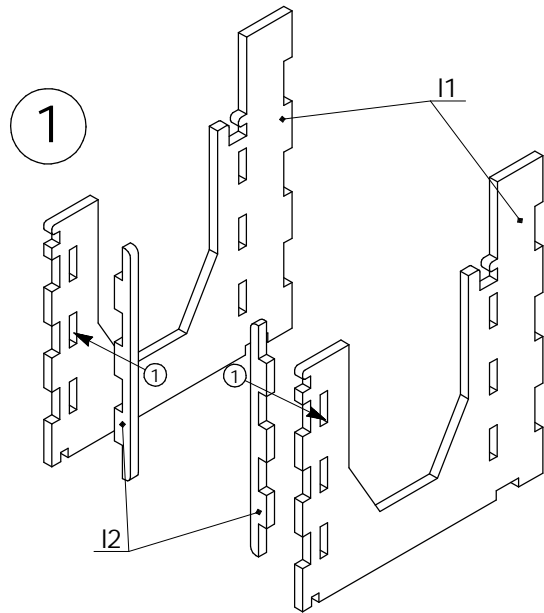

Tokens Tray (x12)
(Parts J; Sheets 24-29)
Each sheet contains parts for two trays

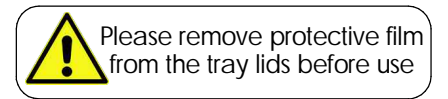
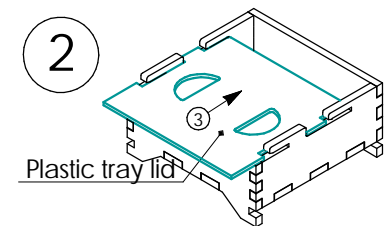
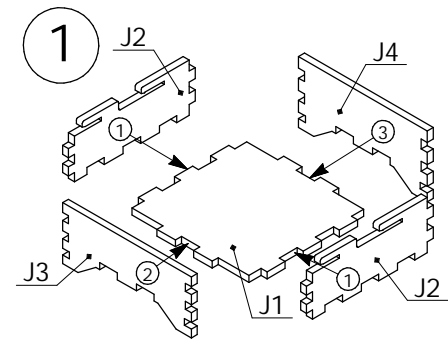

Monuments Tray
(Parts H; Sheets 2, 10, 11)

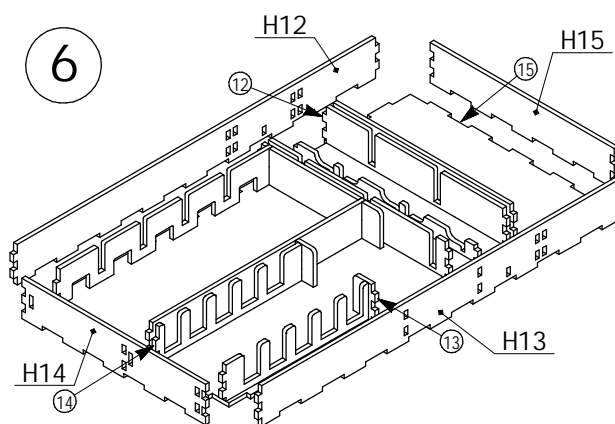
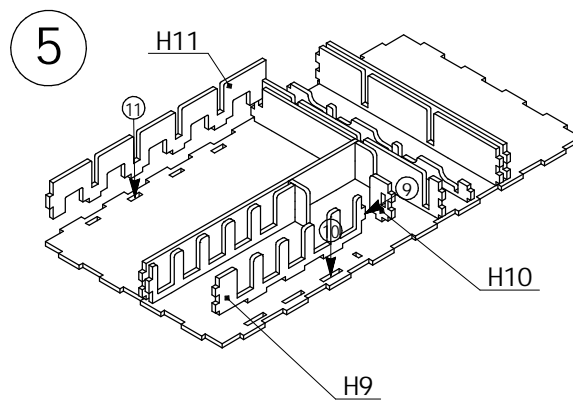
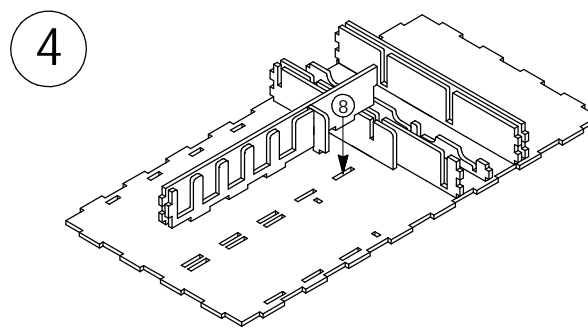
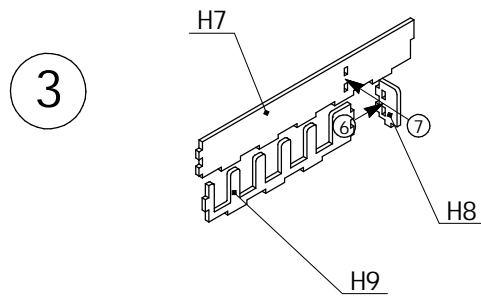
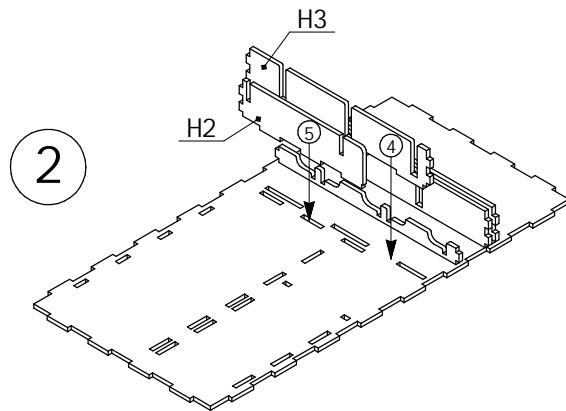
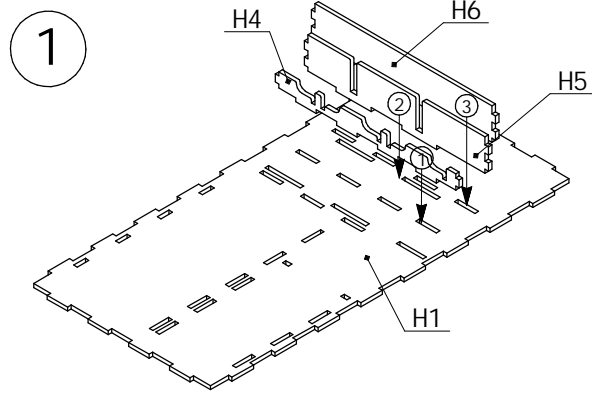

Followers Tray
(Parts K; Sheets 3, 6)

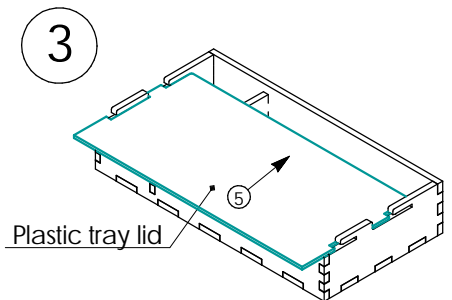
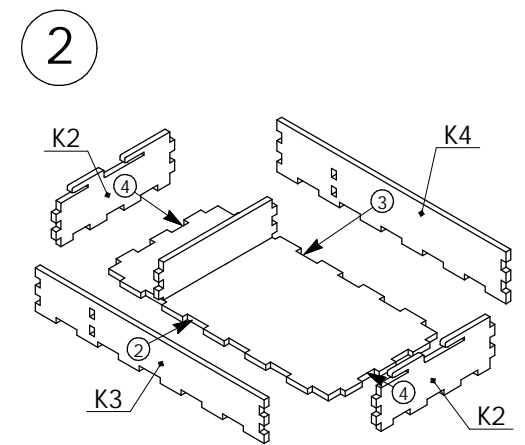
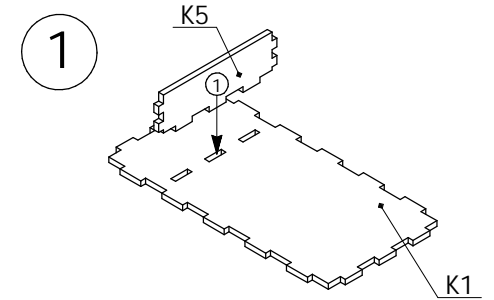

Guardian Tray 1
(Parts D; Sheet 4, 9)

Camel Tray
(Parts E; Sheet 3)

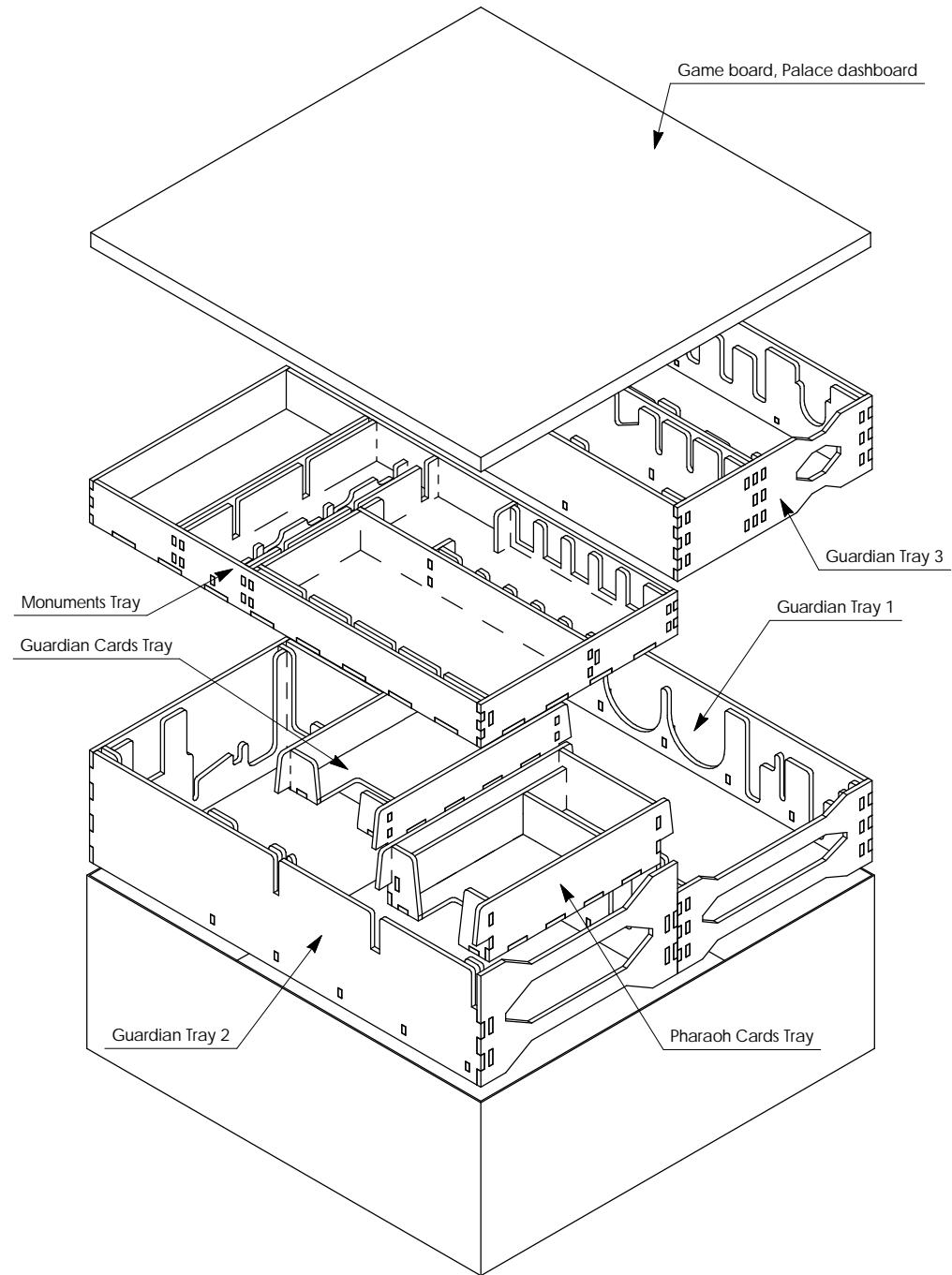
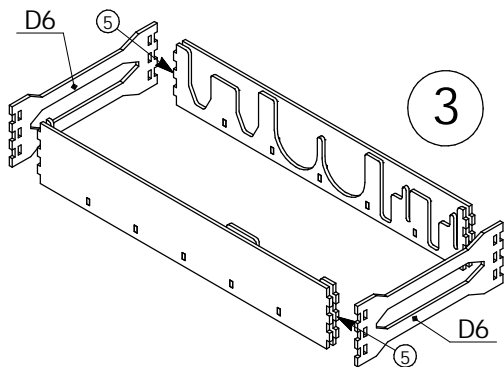
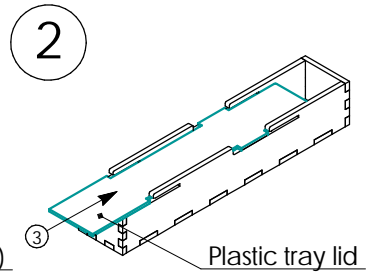
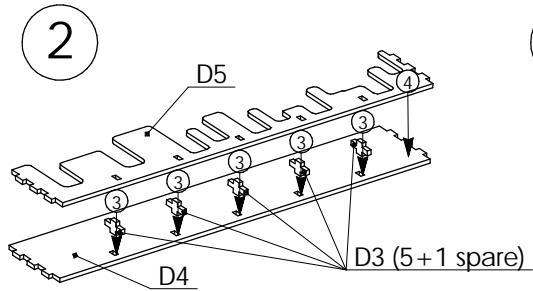
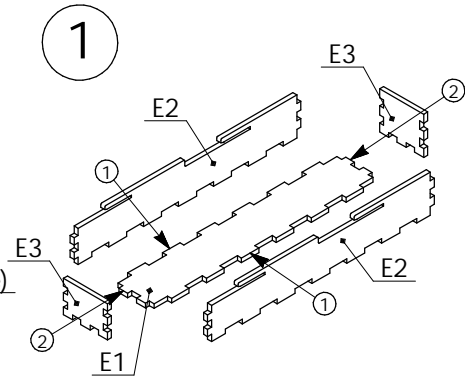
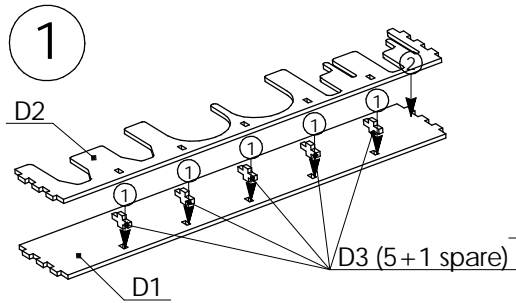

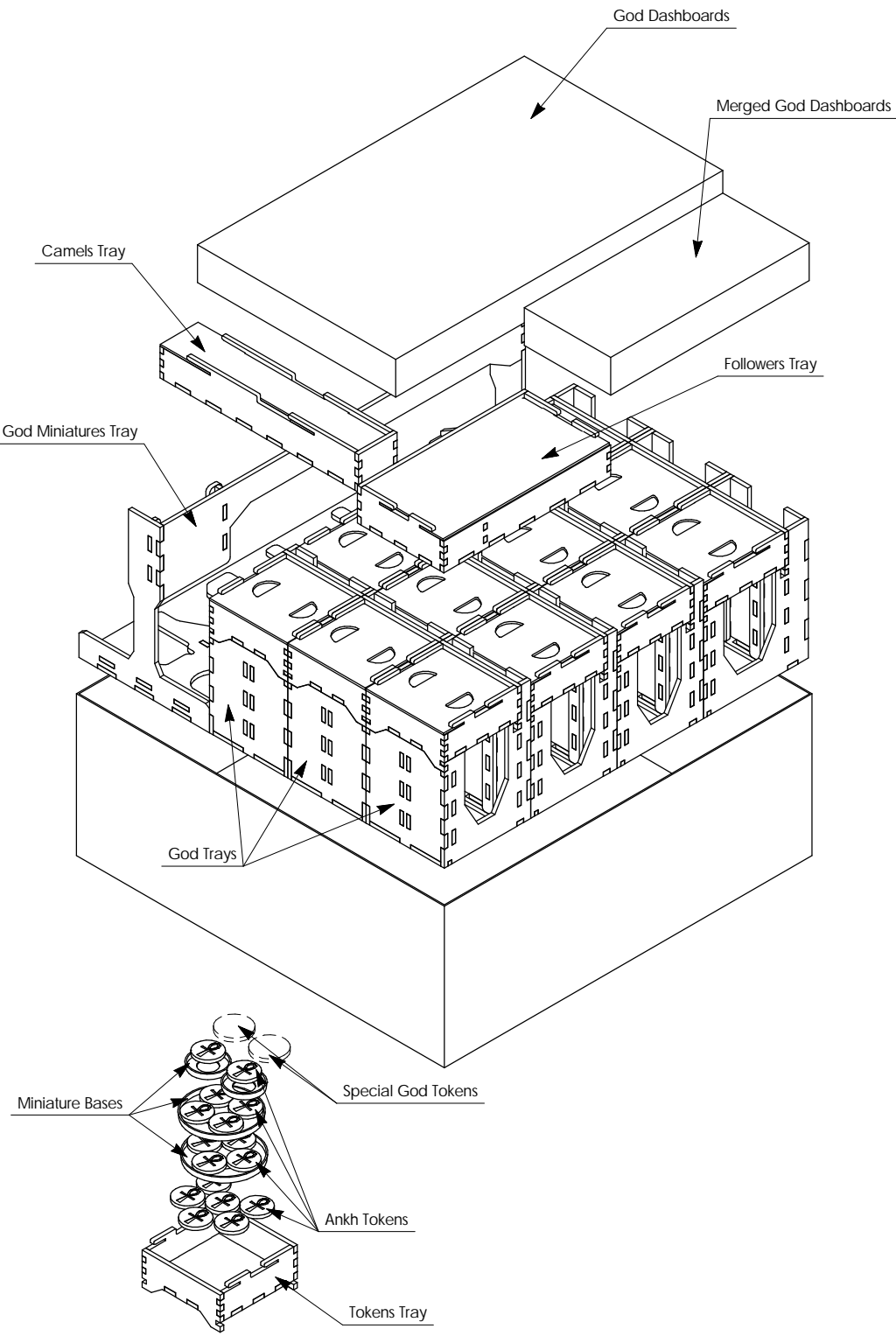

Pharaoh Cards Tray
(Parts F; Sheet 2)

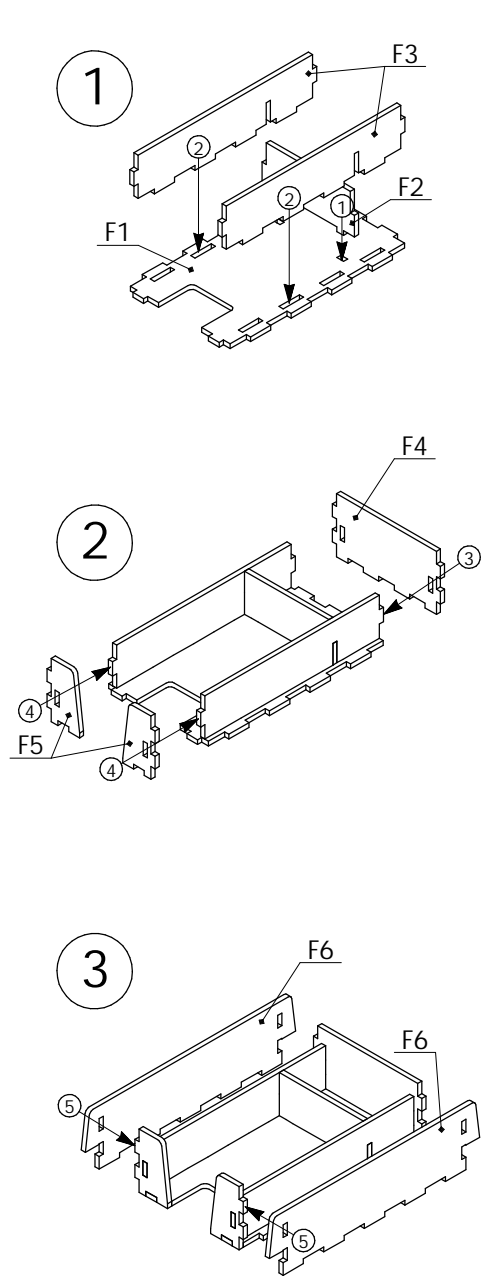

Guardian Cards Tray
(Parts G; Sheet 6)

